

## HMR EVO

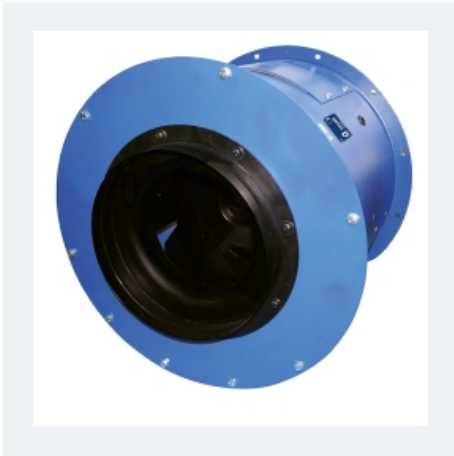

LONG CASE FAN WITH BACKWARD IMPELLER

MANUFACTURING FEATURES:

- Reinforced fan casing manufactured in rolling steel sheet. Polyester powder finishing coat. Housing with motor access door.
- High efficiency backward impeller with self-cleaning system in steel sheet, balanced static and dynamically in origin.
- Models with AC motor inside the air flow. Standard asynchronous squirrel cage motor with IP-55 protection and Class F insulation. Standard voltages of 230V50Hz for single phase motors, 230/400V50Hz & 400/690V 50Hz for three-phase 1 speed motors and 400V50Hz for 2 speed motors.

- Maximum working temperature 60°C.

APPLICATIONS:

Designed for inline installation, they are suitable for:

- Air renewal in buildings and industries.
- Smoke extraction.

## Accessories



**SFC**

## Technical data

### Single-phase motor / 4 poles

Code	Model	R.P.M.	Rated I. A 230V	Rated power kW	Max. Airflow m <sup>3</sup> /h	Sound db (A)**	Weight kg	Connect. diagram
261310343	HMR EVO 315 M4 0,25kW	1400	1,93	0,25	2.080	-	35	1
261350343	HMR EVO 355 M4 0,25kW	1400	1,93	0,25	2.980	-	40,50	1
261400343	HMR EVO 400 M4 0,75kW	1400	5,21	0,75	4.550	-	52	1

### Three-phase motor / 2 poles

Code	Model	R.P.M.	Rated I. A		Rated power kW	Max. Airflow m <sup>3</sup> /h	Sound db (A)**	Weight kg	Connect. diagram
			230V	400V					
261310623	HMR EVO 315 T2 1,1kW	2800	4,05	2,33	1,10	4.150	-	36	2

### Three-phase motor / 4 poles

Code	Model	R.P.M.	Rated I. A		Rated power kW	Max. Airflow m <sup>3</sup> /h	Sound db (A)**	Weight kg	Connect. diagram
			230V	400V					
261310643	HMR EVO 315 T4 0,25kW	1400	1,38	0,79	0,25	2.080	-	35	2
261350643	HMR EVO 355 T4 0,25kW	1400	1,38	0,79	0,25	2.980	-	40,50	2
261400643	HMR EVO 400 T4 0,75kW	1390	3,5	2,00	0,75	4.550	-	52	2
261450643	HMR EVO 450 T4 1,1kW	1450	4,33	2,49	1,10	6.790	-	68	2
261500643	HMR EVO 500 T4 1,5kW	1450	5,67	3,26	1,50	8.930	-	89	2
261560643	HMR EVO 560 T4 3kW	1420	10,7	6,17	3,00	12.670	-	120	2
261630643	HMR EVO 630 T4 5,5kW	1460	-	10,5	5,50	18.760	-	170	2

### Three-phase motor / 6 poles

Code	Model	R.P.M.	Rated I. A		Rated power kW	Max. Airflow m <sup>3</sup> /h	Sound db (A)**	Weight kg	Connect. diagram
			230V	400V					
261500663	HMR EVO 500 T6 0,55kW	925	3,39	1,95	0,75	5.860	-	90	2
261560663	HMR EVO 560 T6 0,75kW	910	3,79	2,18	0,75	8.320	-	118	2
261630663	HMR EVO 630 T6 1,5kW	940	6,45	3,71	1,50	12.490	-	164	2

### 2 speed motor / 4/8 poles

Code	Model	R.P.M.	Rated I. A 400V	Rated power kW	Max. Airflow m <sup>3</sup> /h	Sound db (A)**	Weight kg	Connect. diagram
2613106432V	HMR EVO 315 T4/T8 0,25/0,03kW	1370	1,13/0,37	0,25	2.080	-	35	3
2613506432V	HMR EVO 355 T4/T8 0,25/0,03kW	1370	1,13/0,37	0,25	2.980	-	40,50	3
2614006432V	HMR EVO 400 T4/T8 0,75/0,12kW	1400	2,03/0,68	0,75	4.550	-	52	3
2614506432V	HMR EVO 450 T4/T8 1,1/0,18kW	1400	2,67/1,08	1,10	6.790	-	68	3
2615006432V	HMR EVO 500 T4/T8 1,5/0,25kW	1400	3,46/1,27	1,50	8.930	-	89	3
2615606432V	HMR EVO 560 T4/T8 3/0,55kW	1430	6,53/2,33	3,00	12.670	-	120	3
2616306432V	HMR EVO 630 T4/T8 5,5/1,1kW	1450	10,73/3,82	5,50	18.760	-	170	3

**Notes:**

\*\* Total sound pressure level at the point of maximum flow measured in dB(A) in the suction measured in free field at a distance of 6m from the source

## Dimensions

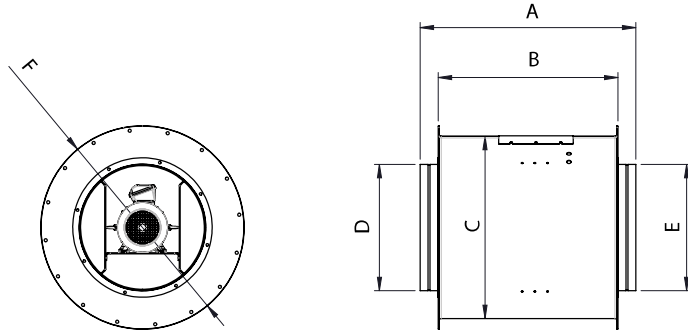

Model	A	B	C	D	E	F
HMR EVO 315 M4 0,25kW	642	500	508	353	353	600
HMR EVO 315 T2 1,1kW	642	500	508	353	353	600
HMR EVO 315 T4 0,25kW	642	500	508	353	353	600
HMR EVO 315 T4/T8 0,25/0,03kW	642	500	508	353	353	600
HMR EVO 355 M4 0,25kW	705	563	563	398	398	649
HMR EVO 355 T4 0,25kW	705	563	563	398	398	649
HMR EVO 355 T4/T8 0,25/0,03kW	705	563	563	398	398	649
HMR EVO 400 M4 0,75kW	774	632	637	448	448	725
HMR EVO 400 T4 0,75kW	774	632	637	448	448	725
HMR EVO 400 T4/T8 0,75/0,12kW	774	632	637	448	448	725
HMR EVO 450 T4 1,1kW	851	709	719	498	498	802
HMR EVO 450 T4/T8 1,1/0,18kW	851	709	719	498	498	802
HMR EVO 500 T4 1,5kW	929.5	787.5	805	558	558	892
HMR EVO 500 T6 0,55kW	929.5	787.5	805	558	558	892
HMR EVO 500 T4/T8 1,5/0,25kW	929.5	787.5	805	558	558	892
HMR EVO 560 T4 3kW	1027.5	885.5	908.5	628	628	1000
HMR EVO 560 T6 0,75kW	1027.5	885.5	908.5	628	628	1000
HMR EVO 560 T4/T8 3/0,55kW	1027.5	885.5	908.5	628	628	1000
HMR EVO 630 T4 5,5kW	1137.5	995.5	1019	708	708	1116
HMR EVO 630 T6 1,5kW	1137.5	995.5	1019	708	708	1116
HMR EVO 630 T4/T8 5,5/1,1kW	1137.5	995.5	1019	708	708	1116

## Wiring diagram

### Wiring diagram N° 1

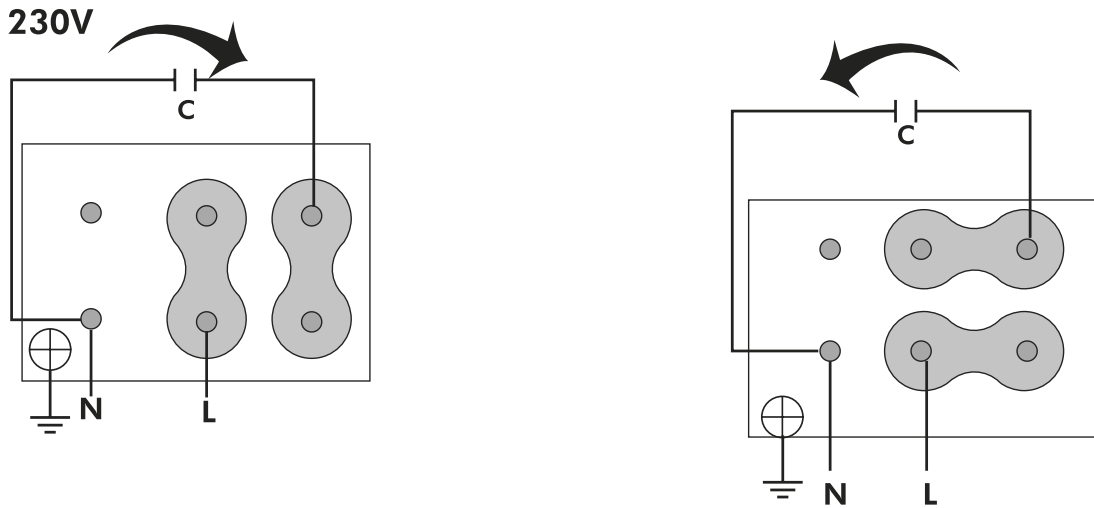

### Wiring diagram N° 2

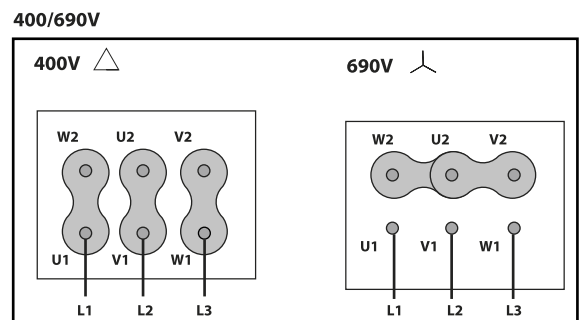
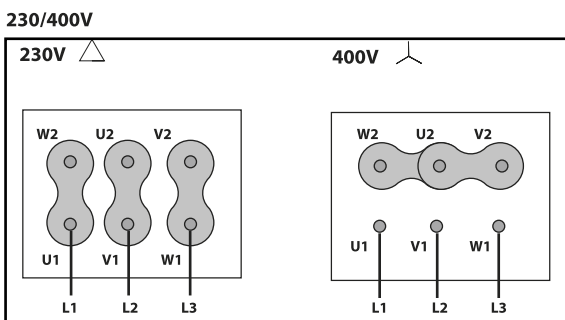

Wiring diagram N° 3

400V DAHLANDER (Y,YY)

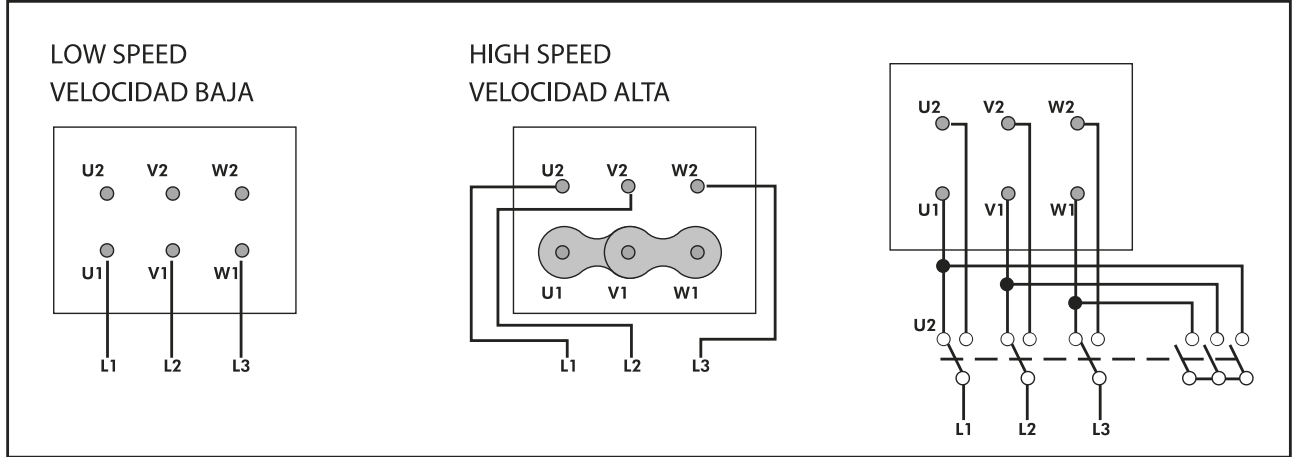

# CHARACTERISTIC CURVE

1 HMR EVO 315 M4 0,25kW

2 HMR EVO 355 M4 0,25kW

3 HMR EVO 400 M4 0,75kW

## AIR FLOW - PRESSURE

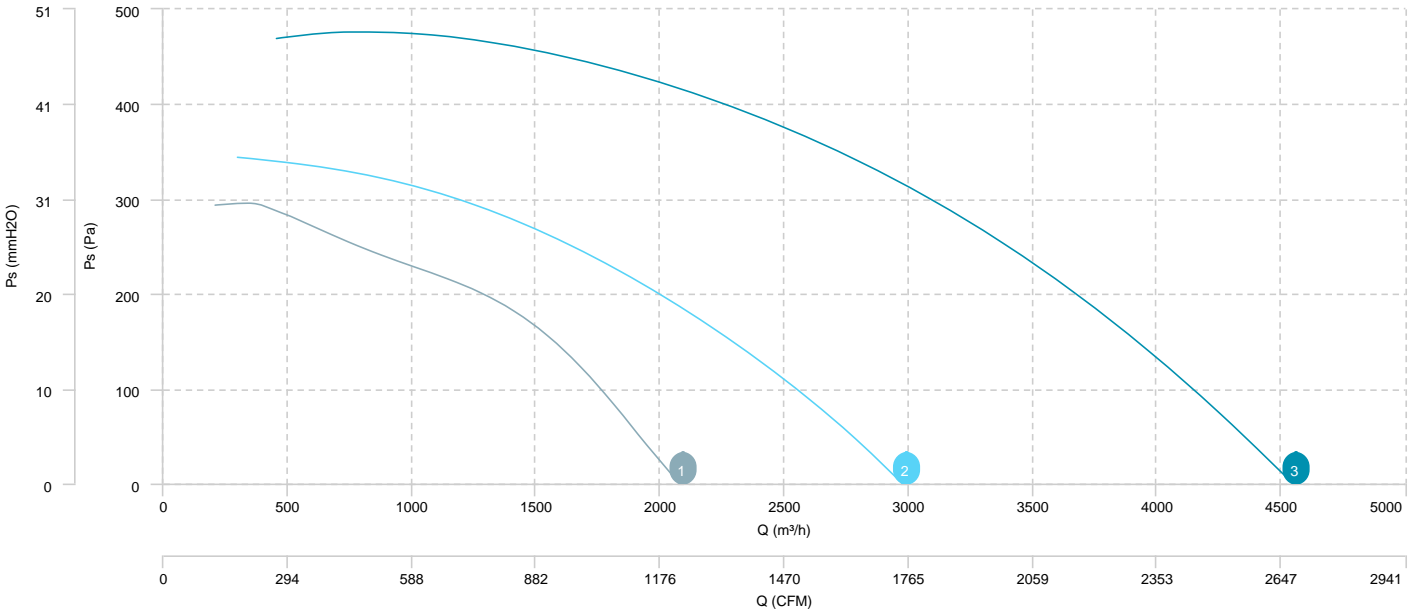

## AIR FLOW - ABSORBED POWER

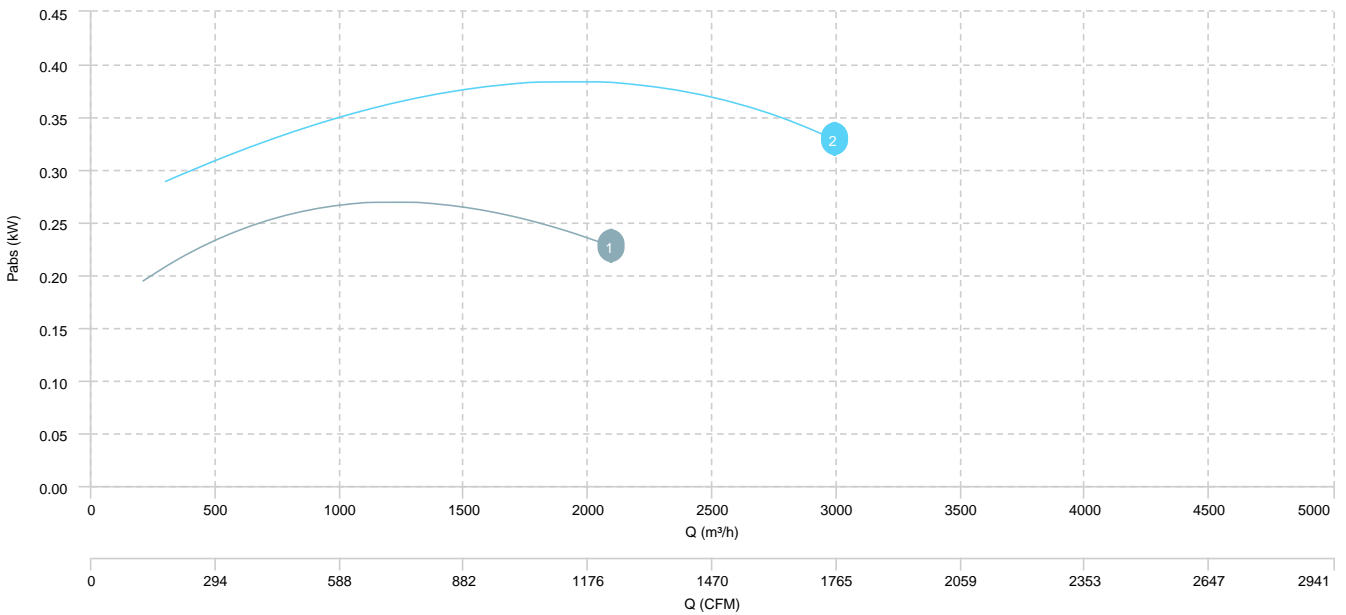

1 HMR EVO 315 T2 1,1kW

AIR FLOW - PRESSURE

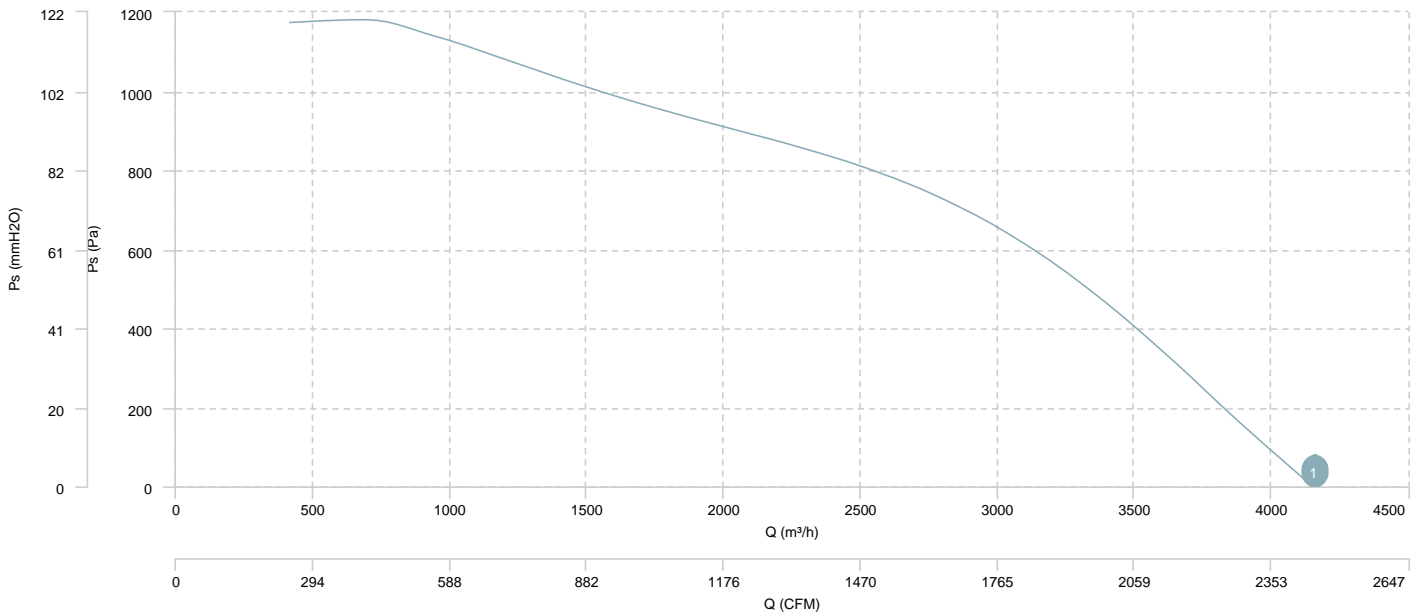

AIR FLOW - ABSORBED POWER

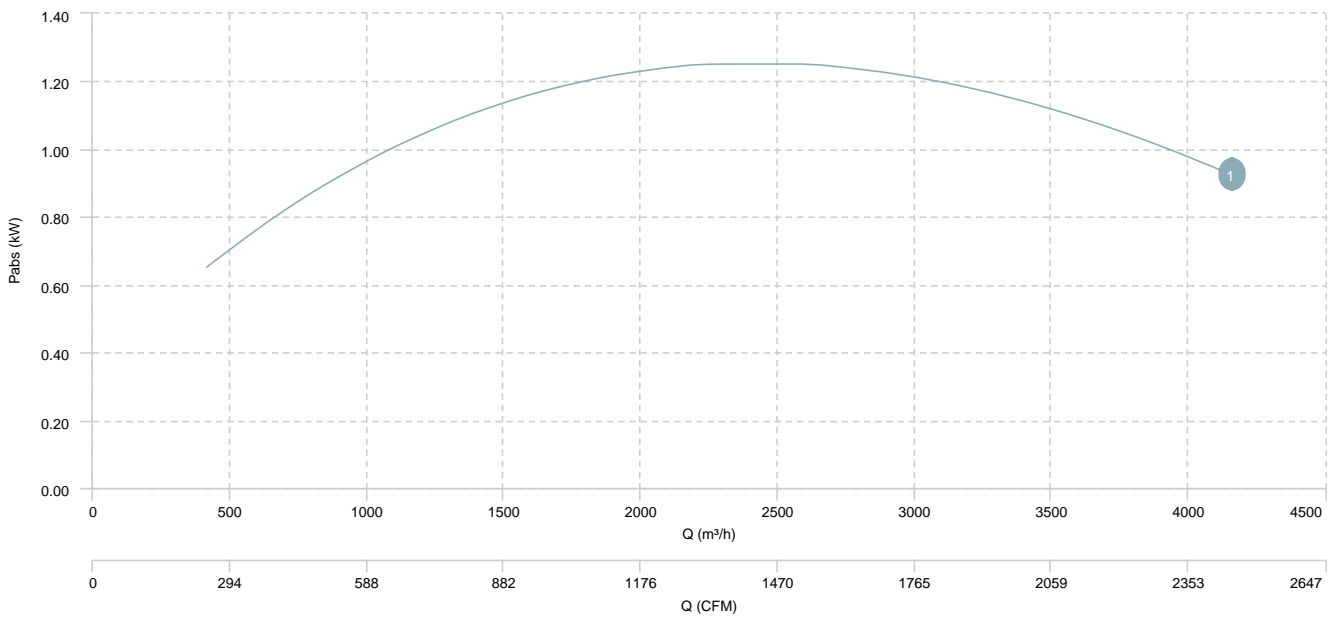



1	HMR EVO 315 T4 0,25kW	2	HMR EVO 355 T4 0,25kW	3	HMR EVO 400 T4 0,75kW	4	HMR EVO 450 T4 1,1kW
5	HMR EVO 500 T4 1,5kW	6	HMR EVO 560 T4 3kW	7	HMR EVO 630 T4 5,5kW		

## AIR FLOW - PRESSURE

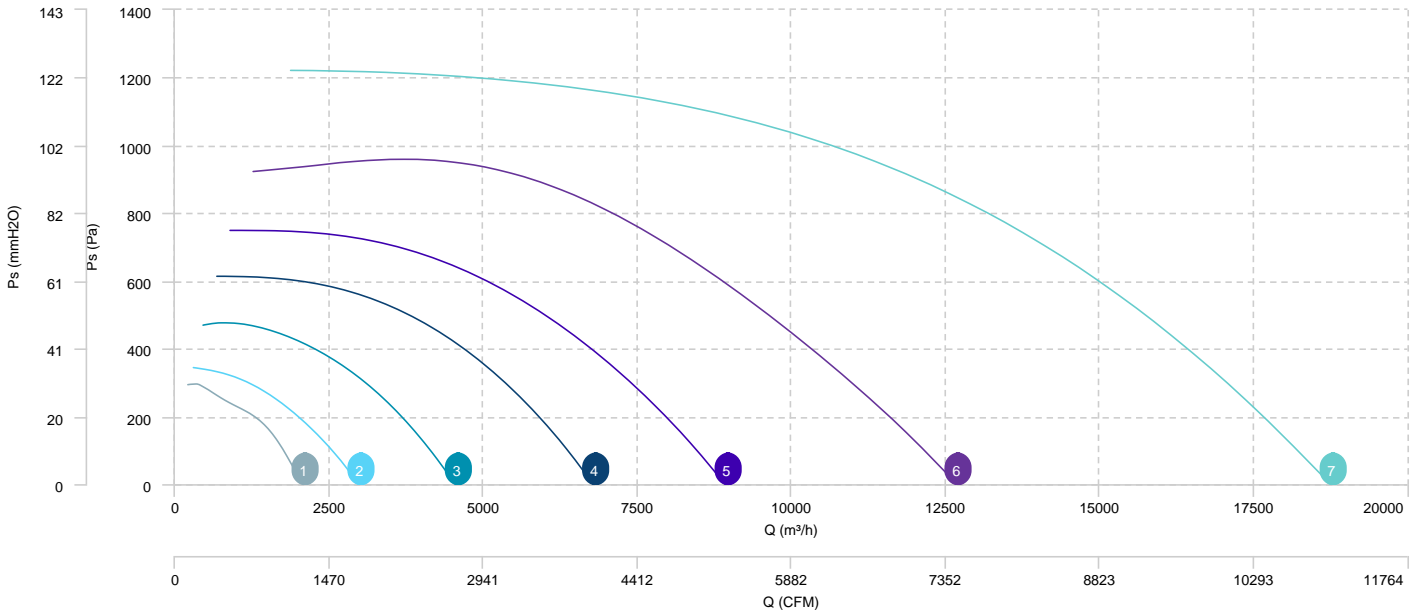

## AIR FLOW - ABSORBED POWER

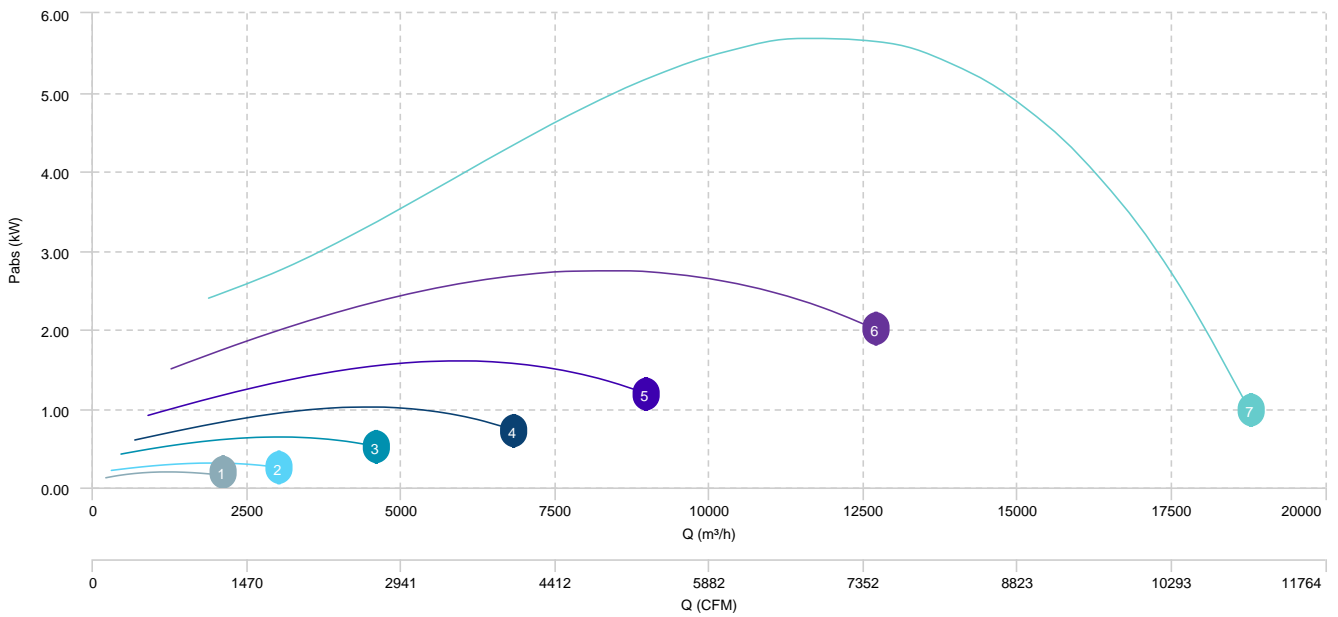

1 HMR EVO 500 T6 0,55kW

2 HMR EVO 560 T6 0,75kW

3 HMR EVO 630 T6 1,5kW

## AIR FLOW - PRESSURE

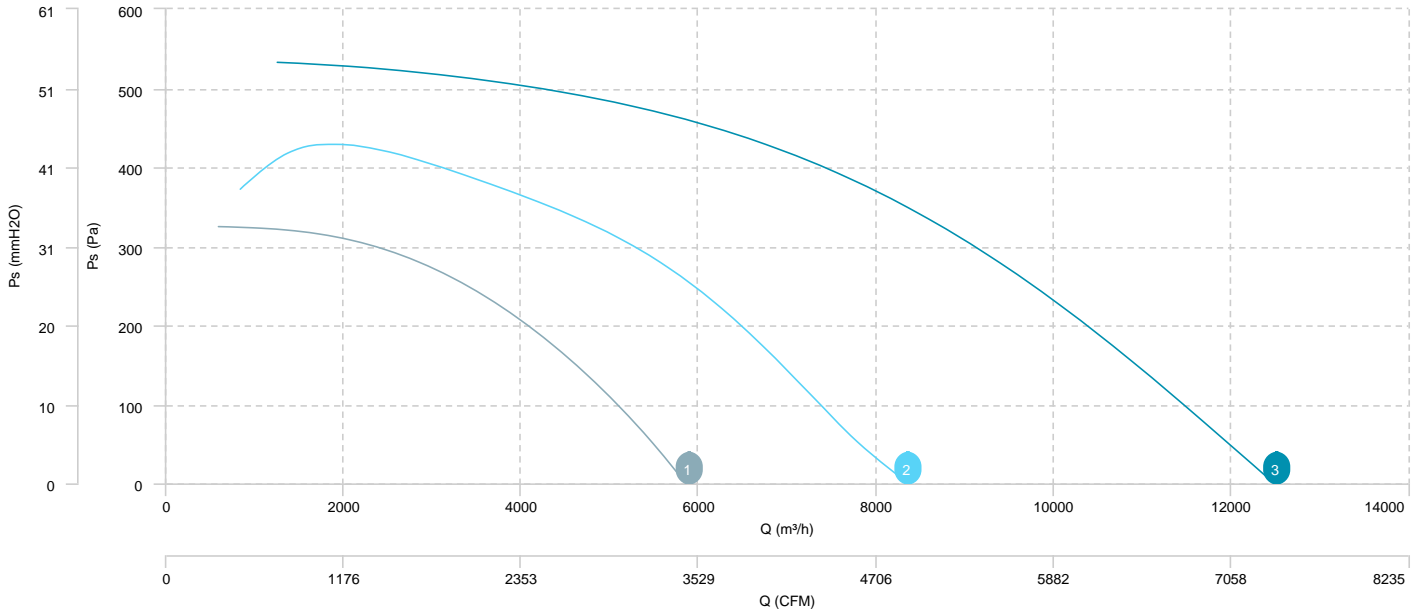

## AIR FLOW - ABSORBED POWER

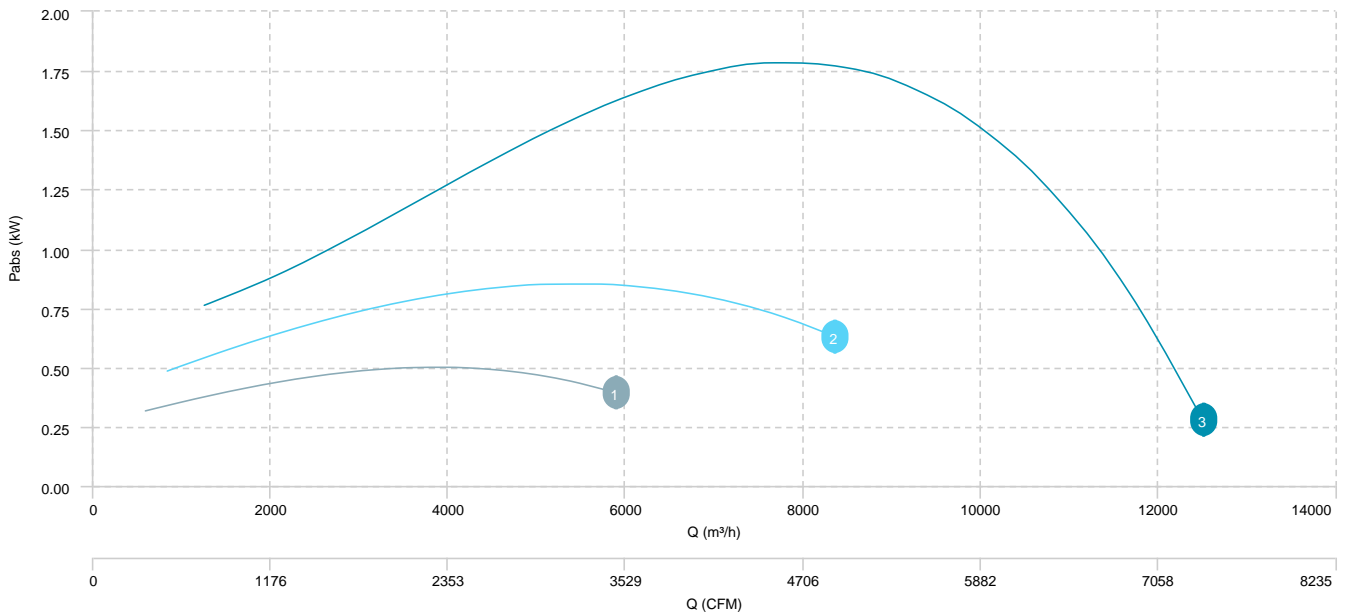

1	HMR EVO 315 T4/T8 0, 25/0,03kW	2	HMR EVO 355 T4/T8 0, 25/0,03kW	3	HMR EVO 400 T4/T8 0, 75/0,12kW	4	HMR EVO 450 T4/T8 1, 1/0,18kW
5	HMR EVO 500 T4/T8 1, 5/0,25kW	6	HMR EVO 560 T4/T8 3/0, 55kW	7	HMR EVO 630 T4/T8 5, 5/1,1kW		

**AIR FLOW - PRESSURE (4 poles)**

1	HMR EVO 315 T4/T8 0, 25/0,03kW	2	HMR EVO 355 T4/T8 0, 25/0,03kW	3	HMR EVO 400 T4/T8 0, 75/0,12kW	4	HMR EVO 450 T4/T8 1, 1/0,18kW
5	HMR EVO 500 T4/T8 1, 5/0,25kW	6	HMR EVO 560 T4/T8 3/0, 55kW	7	HMR EVO 630 T4/T8 5, 5/1,1kW		

## AIR FLOW - PRESSURE (8 poles)

## erp data

ERP	
Fan type	Unit for non-residential ventilation (LOT 6)
Typology	Unidirectional
Others	None
Type of driver	-

### ERP / 2 poles

Model	Motor power (kW)	Maximum efficiency point data						
		Eff.Heat recovery (%)	Max. efficiency (%)	Pabs (kW)	Air Flow (m <sup>3</sup> /h)	Ps (Pa)	Speed (m/s)	SFP (W/m <sup>3</sup> /s)
HMR EVO 315 T2 1,1kW ()	1,10	-	46,77	1,25	2.559,30	796,26	3.51	1.759,82

### ERP / 4 poles

Model	Motor power (kW)	Maximum efficiency point data						
		Eff.Heat recovery (%)	Max. efficiency (%)	Pabs (kW)	Air Flow (m <sup>3</sup> /h)	Ps (Pa)	Speed (m/s)	SFP (W/m <sup>3</sup> /s)
HMR EVO 315 T4 0,25kW	0,25	-	37,53	0,20	1.280,10	200,86	1.75	550,45
HMR EVO 355 T4 0,25kW	0,25	-	38,47	0,31	1.690,76	244,47	1.89	651,51
HMR EVO 400 T4 0,75kW	0,75	-	42,93	0,63	2.634,98	360,20	2.3	863,81
HMR EVO 450 T4 1,1kW	1,10	-	54,98	1,01	4.017,55	478,44	2.75	905,19
HMR EVO 500 T4 1,5kW	1,50	-	55,45	1,58	5.184,67	588,14	2.83	1.098,23
HMR EVO 560 T4 3kW	3	-	59,81	2,71	7.212,05	789,47	3.09	1.351,39
HMR EVO 630 T4 5,5kW	5,50	-	58,89	5,68	11.415,06	949,20	3.89	1.789,59

### ERP / 6 poles

Model	Motor power (kW)	Maximum efficiency point data						
		Eff.Heat recovery (%)	Max. efficiency (%)	Pabs (kW)	Air Flow (m <sup>3</sup> /h)	Ps (Pa)	Speed (m/s)	SFP (W/m <sup>3</sup> /s)
HMR EVO 500 T6 0,55kW ()	0,75	-	48,94	0,50	3.407,64	248,96	1.86	523,65
HMR EVO 560 T6 0,75kW ()	0,75	-	53,22	0,84	4.657,71	334,55	2	649,05
HMR EVO 630 T6 1,5kW ()	1,50	-	50,77	1,77	7.354,58	402,91	2.51	868,46